

Double / Flag Mount Housing for Round Clocks (V4.7)

Features:

- **Double Mount Configuration:** Provides the option to install 2 analog clocks for a dual-faced time display suspended from the wall or ceiling
- **Flag Mount Configuration:** Provides the option to install a single clock suspended from the wall or ceiling
- Pole is designed to allow threading of electrical / data wires (if applicable)
- Bracket Base Plate is designed to mount on a double gang box
- Robust Design
- Easy to Install

Dimensions:

- Mounting Ring Diameter (does not include clock)
 - 12" (30.4 cm) Mounting Ring:
 - Metal = 12.4" (31.5 cm)
 - SlimLine = 12.5" (31.8 cm)
 - 16" (40.6 cm) Mounting Ring:
 - Metal = 16.3" (41.4 cm)
 - SlimLine = 16.4" (41.9 cm)
- Base Width = 5.7" (14.5 cm)
- Base Height = 6.6" (16.7 cm)



Double / Flag Mount Housing for Round Clocks (V4.7)

Double Mount Configuration:

Double Mount Housing for SlimLine and Brushed Aluminum Analog Clocks:

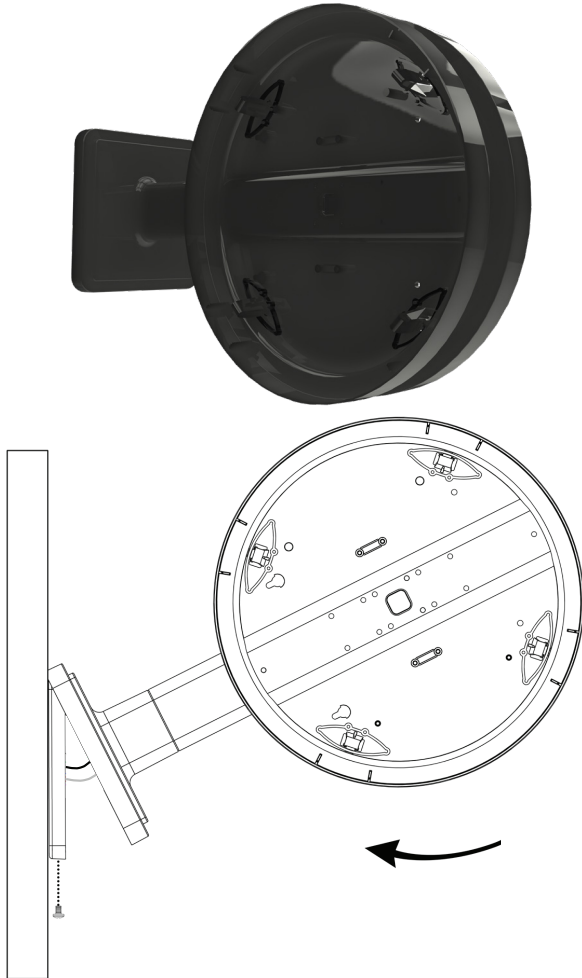

Double Mount Housing for Metal Analog Clocks:

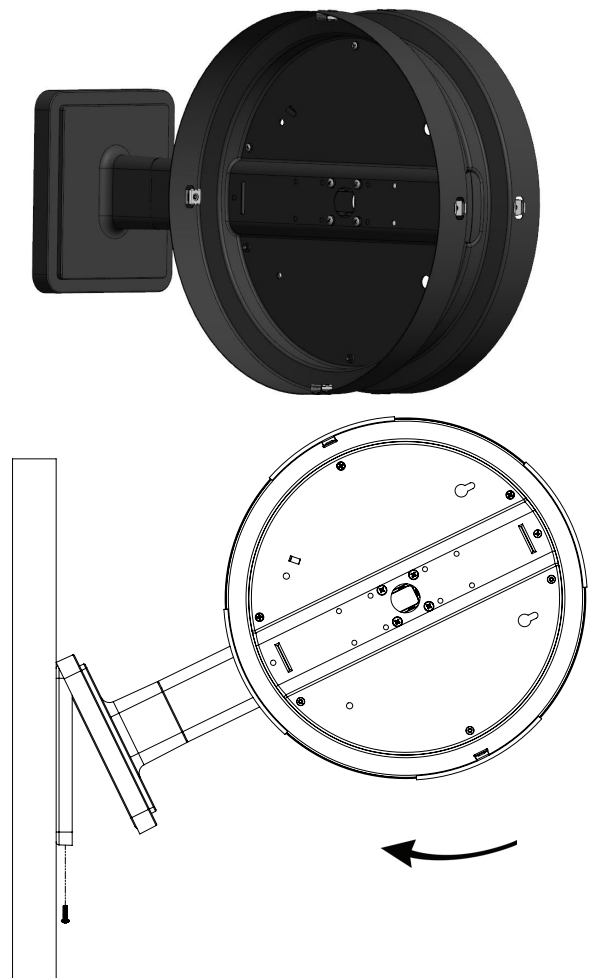

*Ordering Information:

For Double / Flag Mount Housing for clocks with SlimLine and Brushed Aluminum cases:

SAH-1BD-XXR-0

Clock Size:
12: 12"
16: 16"

For Double / Flag Mount Housing for clocks with Metal cases:

SAB-1BD-XXR-0M

Clock Size:
12: 12"
16: 16"

*The same mounting bracket is used for Double Mount and Flag Mounted configuration. When used in a Flag Mounted configuration, one of the round mounting rings (that is meant to hold the clock) is to be removed from the double mount housing. Installation instructions for both configurations are explained in the clock manual.

Note: Double mount configuration will require 2 clocks and 1 double mount housing. Flag mount configuration will require 1 clock and 1 double mount housing.

Specification sheets may change without prior notice

Double / Flag Mount Housing for Round Clocks (V4.7)

Flag Mount Configuration:

Flag Mount Housing for SlimLine and Brushed Aluminum Analog Clocks:

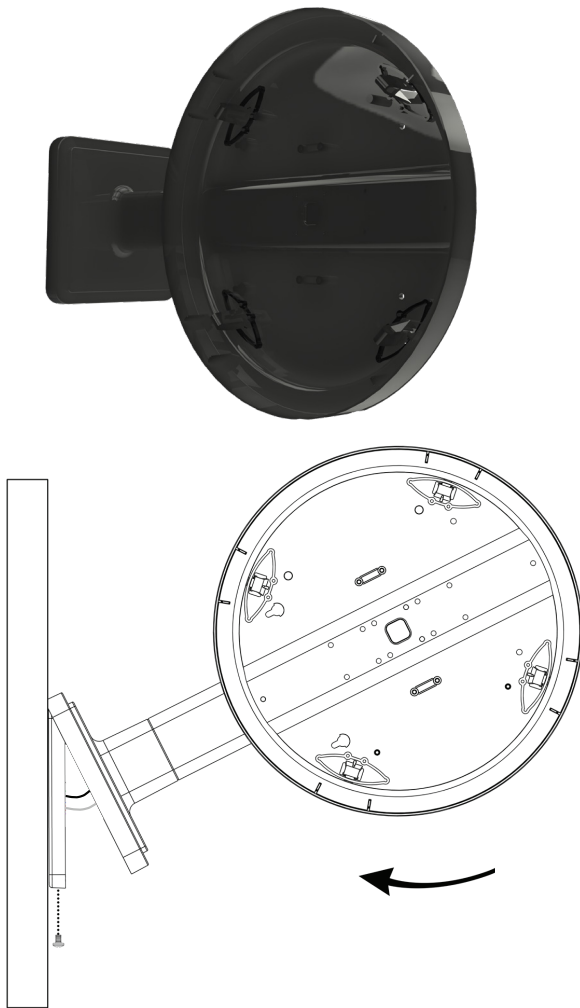

Flag Mount Housing for Metal Analog Clocks:

