

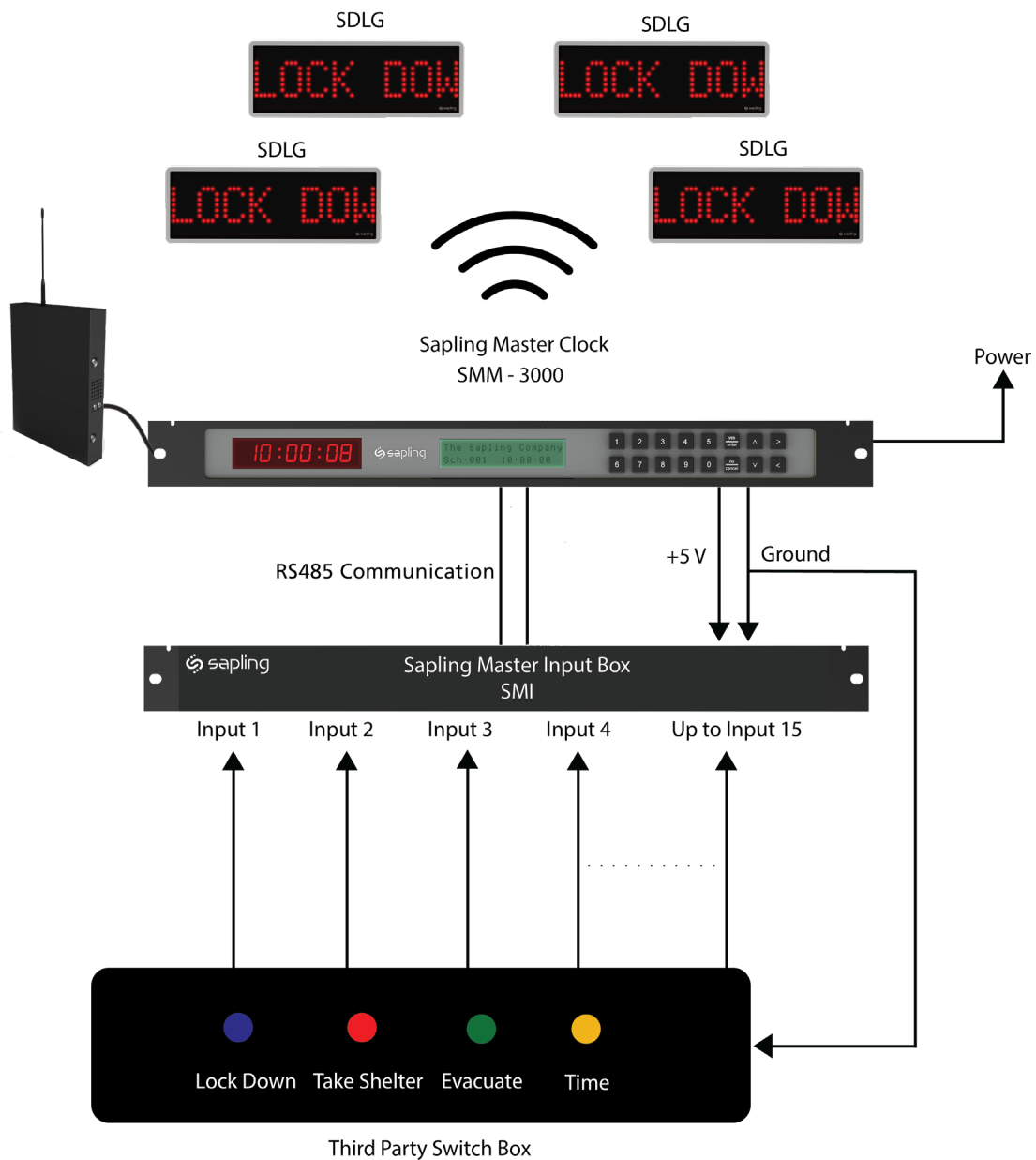

## Sapling Message Clock Line Drawing

**Configuration A - Interfacing with a third party switch panel via contact closure.**



**The Sapling Company, Inc.**

670 Louis Drive, Warminster, Pennsylvania 18974 U.S.A

Phone: +1.215.322.6063 Fax: +1.215.322.8498 Web: [www.sapling-inc.com](http://www.sapling-inc.com)



## Third Party Intercom/Paging System

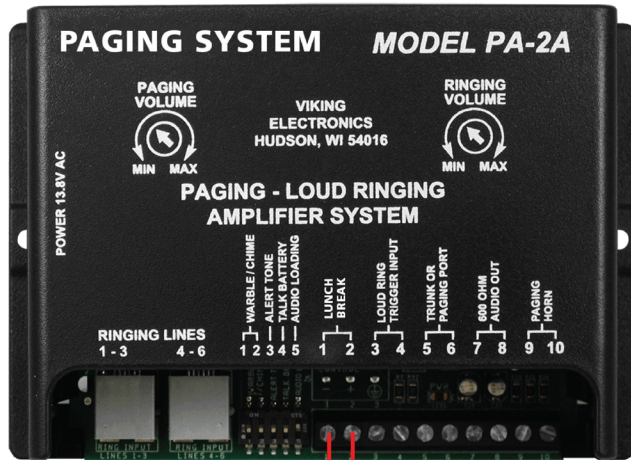

*Configuration B* - Interfacing with a third party intercom/paging system via contact closure.

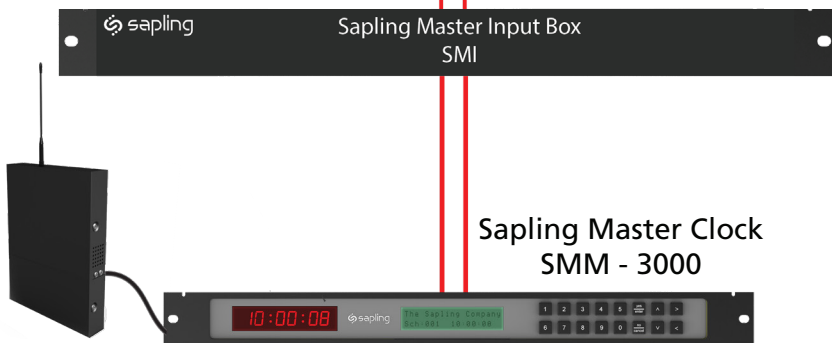



## Wireless Smart Switch

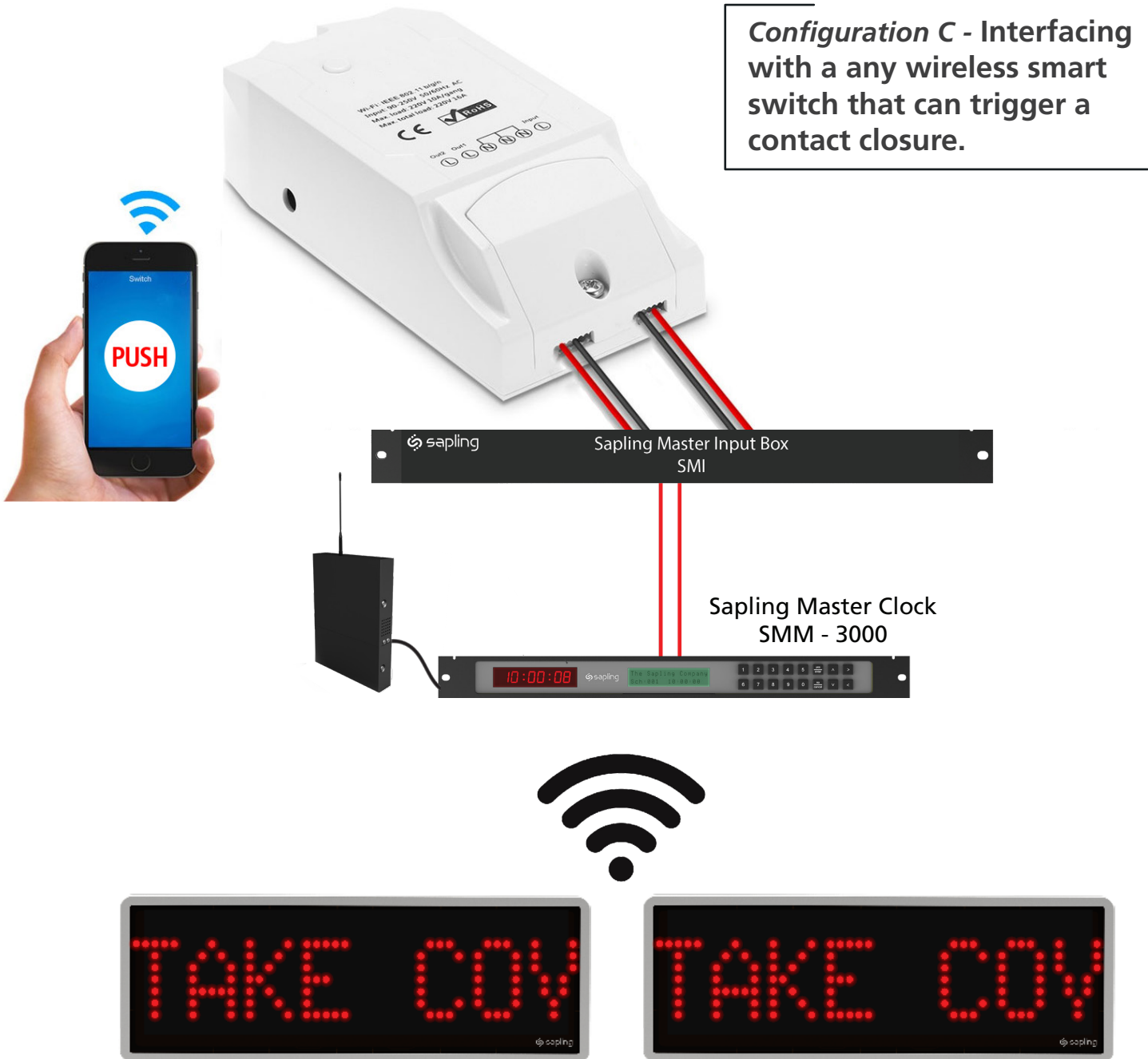



## Prescheduled Messages

**Configuration D - Sapling Master Clock triggering prescheduled messages using its built-in programmable relays.**

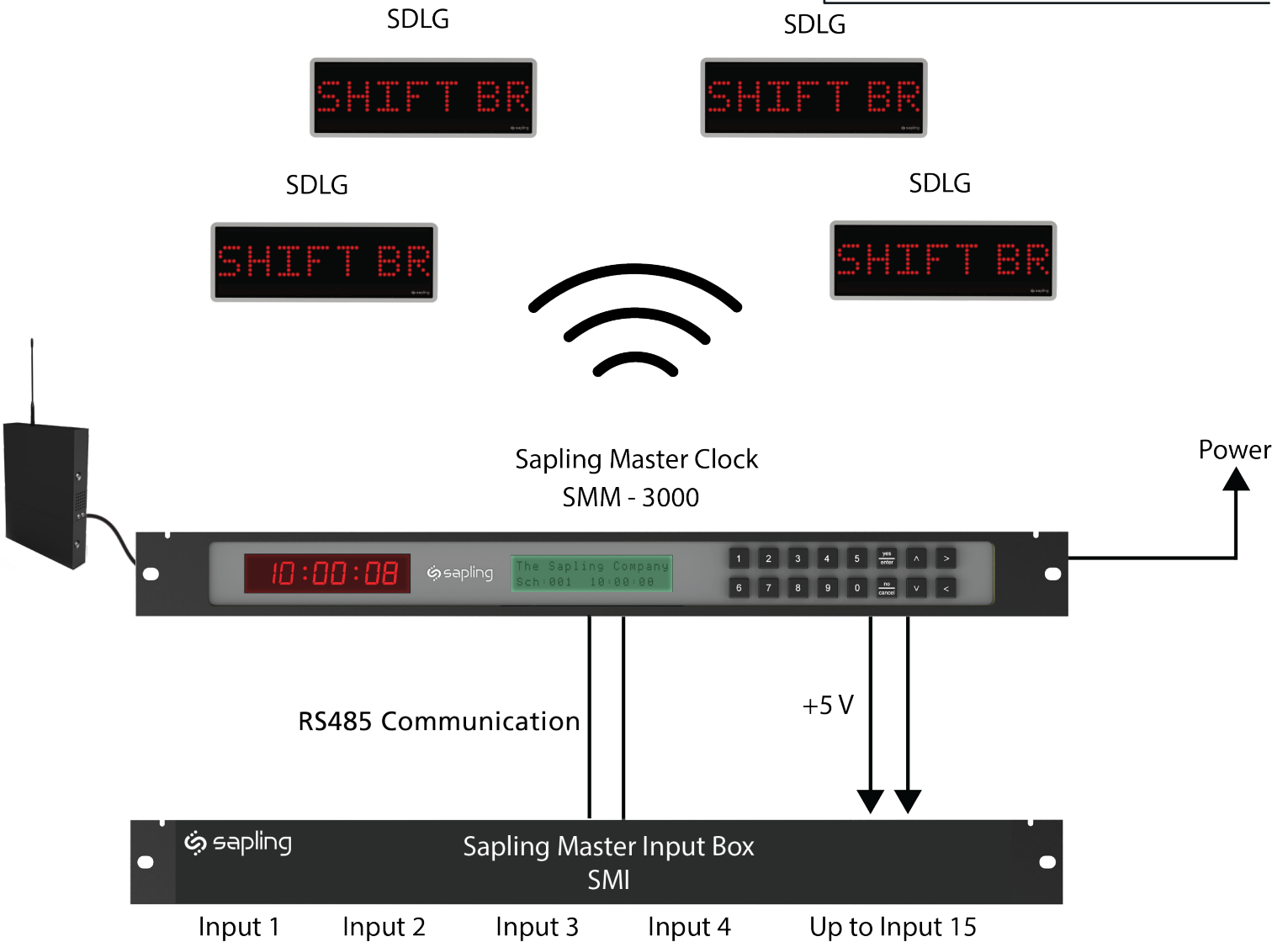

**The Sapling Company, Inc.**

670 Louis Drive, Warminster, Pennsylvania 18974 U.S.A

Phone: +1.215.322.6063 Fax: +1.215.322.8498 Web: [www.sapling-inc.com](http://www.sapling-inc.com)



## Sapling Wireless Message Clock System - Hybrid Solution

**Configuration E - Sapling SMM Master Clock transmitting time data to Sapling Wireless Clocks.**

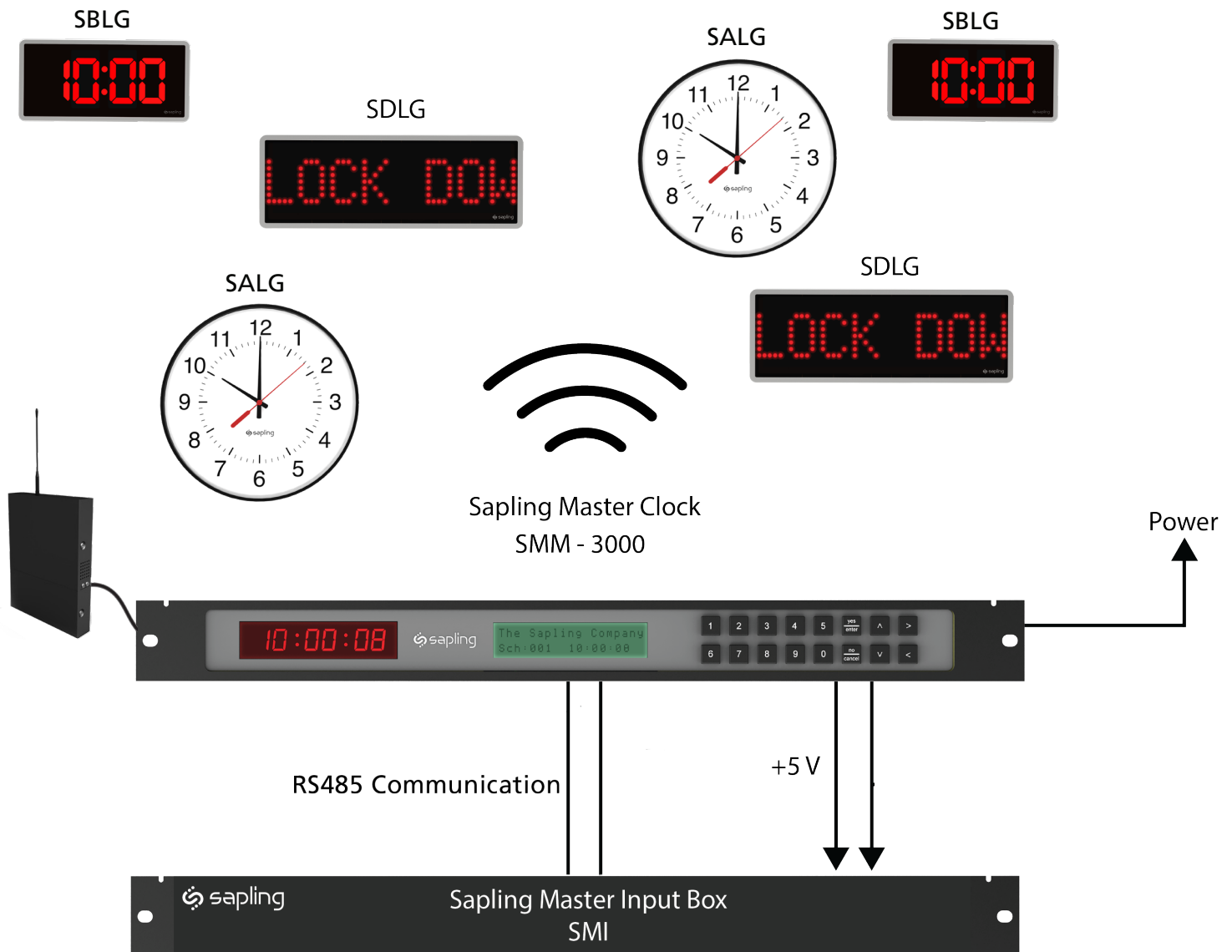

**The Sapling Company, Inc.**

670 Louis Drive, Warminster, Pennsylvania 18974 U.S.A

Phone: +1.215.322.6063 Fax: +1.215.322.8498 Web: [www.sapling-inc.com](http://www.sapling-inc.com)



## Sapling Wireless Message System - Campus Environment

*Configuration F - Campus environment solution when buildings are connected via LAN using a master clock in the main building and network repeaters in the secondary buildings.*

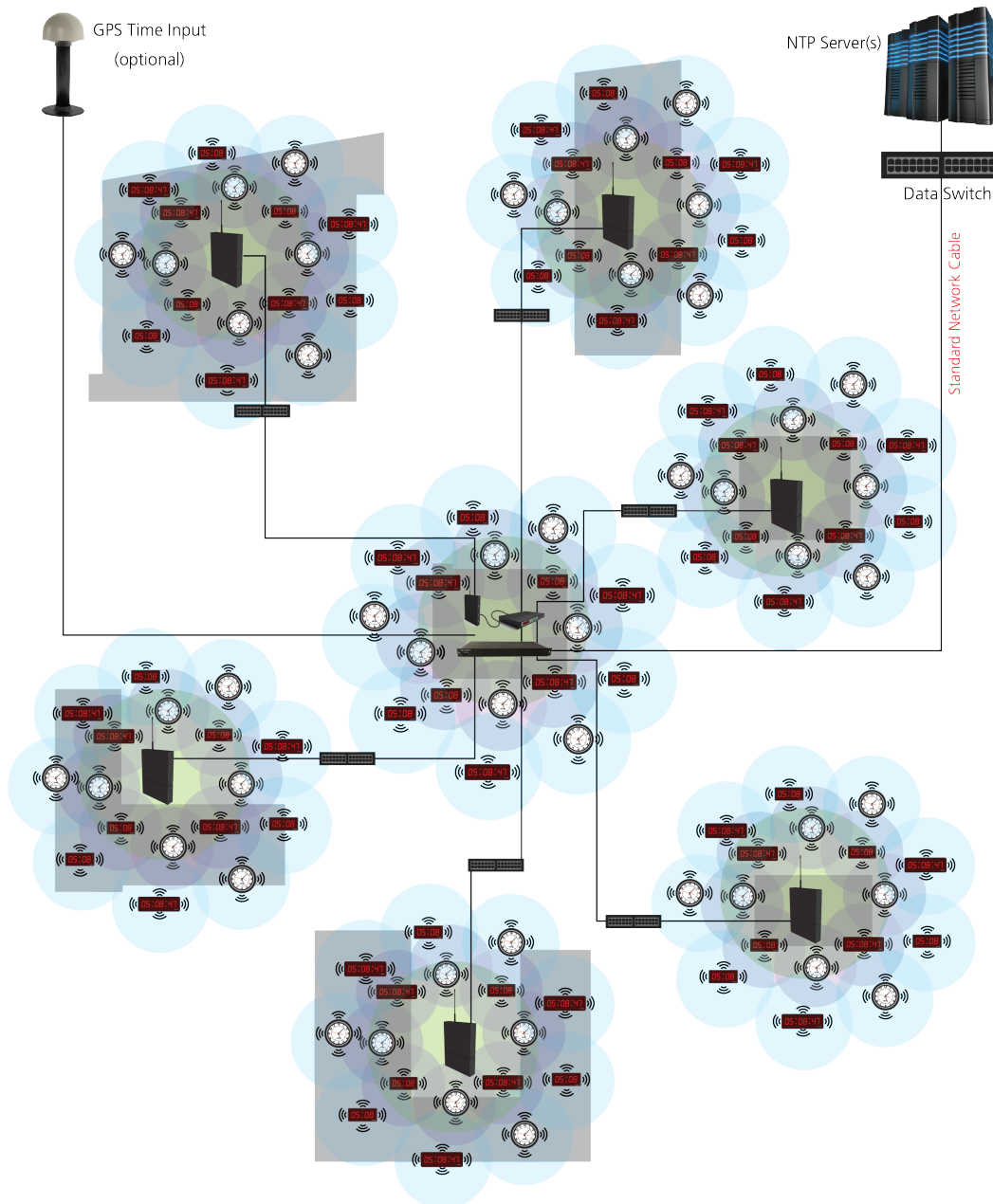

**The Sapling Company, Inc.**

670 Louis Drive, Warminster, Pennsylvania 18974 U.S.A

Phone: +1.215.322.6063 Fax: +1.215.322.8498 Web: [www.sapling-inc.com](http://www.sapling-inc.com)